



53rd Annual Meeting

Rosen Centre Hotel

Orlando, Florida

2008 FERA Program Summary

Wednesday, November 19, 2008

10 a.m. - 5 p.m.	Registration @ Desk 4			
12 noon - 1:30 p.m.	1.0 Opening Session Salon 11 Invited Speaker: Isadore Newman, Florida International University <i>A Statistical Therapist Approach for Facilitating Communication in Guiding Research and Evaluation</i>			Sponsors Salon Salon 12 <i>Coffee and light refreshments</i>
1:45 - 3:15 p.m.	1.1 paper session Salon 13	1.2 paper session Salon 14	1.3 Symposium Salon 15	Sponsors Salon Salon 12
3:30 - 5 p.m.	2.1 paper session Salon 13	2.2 paper session Salon 14	2.3 paper session Salon 15	Sponsors Salon Salon 12
5:30 - 6:45 p.m.	3.0 DOE Session Salon 11 <i>State of the Art for Assessing Special Populations</i> Claudia Flowers, UNC at Charlotte Moderator: Cornelia Orr			
7 - 9 p.m.	4.0 Welcome Reception			Signature 1

Thursday, November 20, 2008

8:30 a.m. - 5:00 p.m.	Registration @ Desk 4			
9:30 - 11 a.m.	5.0 Invited Address Salon 11 Noel Smith, Curator of Education & Sarah Howard, Research Associate <i>USF Graphicstudio Institute for Research in Art: Emphasis on "Research"</i>			Sponsors Salon Salon 12 <i>Coffee and light refreshments</i>
11:15 - 12:45	6.1 Graduate Student Meeting Salon 13	6.2 paper session Salon 14	6.3 paper session Salon 15	Sponsors Salon Salon 12
12:45 - 1:45	<i>Lunch on your own</i>			
2:00 p.m. - 3:30 p.m.	7.1 paper session Salon 13	7.2 paper session Salon 14	7.3 Action Research Workshop Terek Chebbi, Miami- Dade Public Schools	7.4 graduate student poster session Salon 16
3:45 - 5:15 p.m.	8.1 FATA Session Salon 13	8.2 paper session Salon 14	8.3 paper Session Salon 15	8.4 graduate student posters on display Salon 16
5:30 - 7:30 p.m.	Evening Reception <i>Sponsored by Educational Testing Service</i>			Signature 2

Friday, November 21, 2008

8:30 - 11 a.m.	Registration @ Desk 4			
8:30 - 10:00 a.m.	9.1 paper session Salon 13	9.2 paper session Salon 14	9.3 paper session Salon 15	Sponsors Salon Salon 12
10:15 - 11:30	10.0 Keynote Address Salon 11 Luis Miron, Loyola University <i>Managing and Leading in the Midst of Chaos: Lessons Learned from New Orleans</i>			Sponsors Salon Salon 12
12:00 - 1:30 p.m.	FERA Members Luncheon Salons 1 & 2 <i>Sponsored by Pearson</i>			
1:30 - 2:30 p.m.	FERA Executive Board Meeting			Salon 24

Hotel Floor Plan for Session Locations

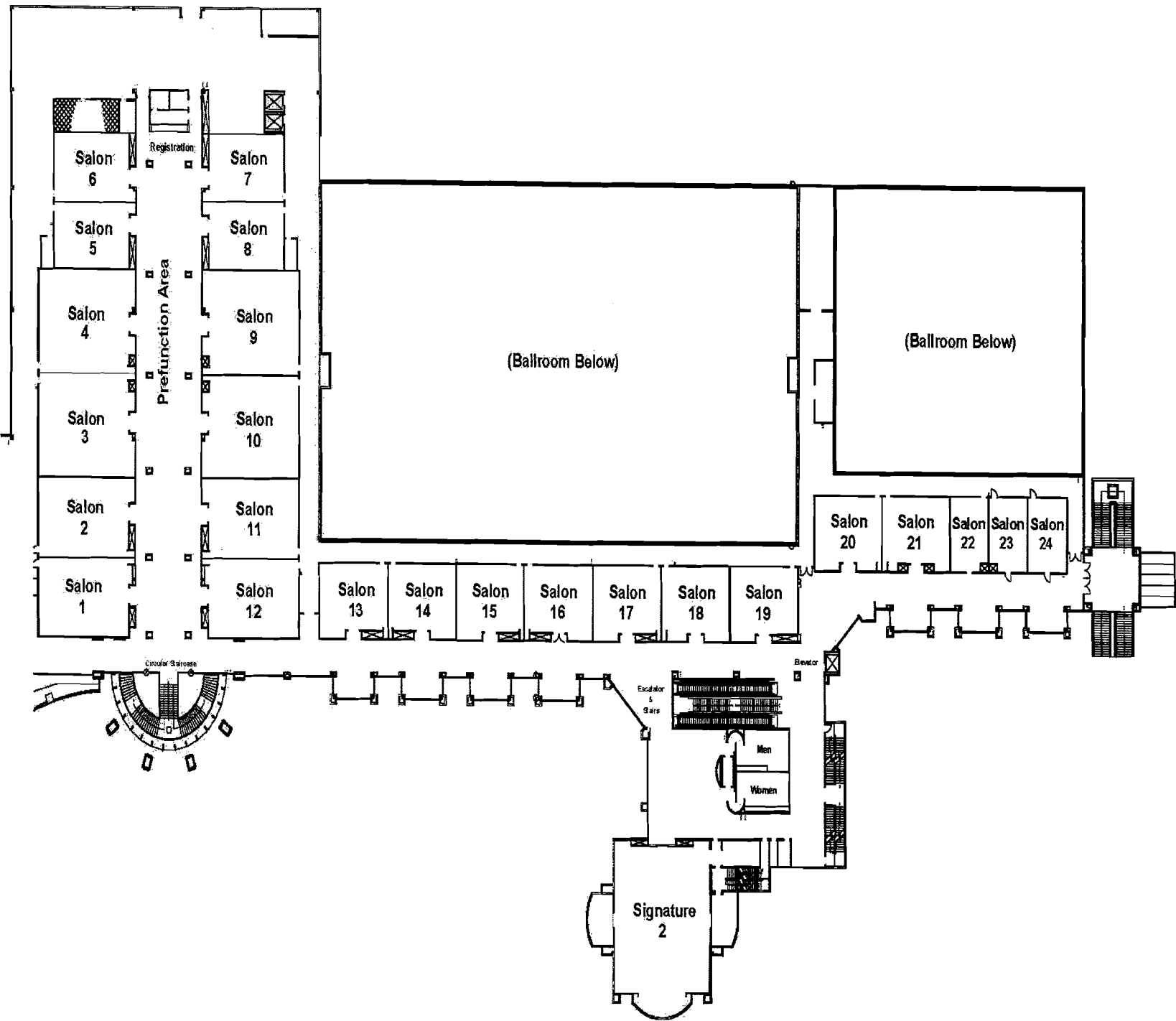

Florida Educational Research Association 53rd Annual Meeting

2008 Program Schedule

November 19 - 21, 2008

Rosen Centre Hotel
Orlando, Florida



Wednesday **November 19, 2008**

10:00 a.m. – 5:00 p.m. **Registration @ Desk 4**

12:00 noon – 1:30 p.m. **Opening Session** **Room: Salon 11**

Welcome Address
Akihito Kamata, President

Invited Address:
***A Statistical Therapist Approach for Facilitating Communication
In Guiding Research and Evaluation***

Isadore Newman
Florida International University
Visiting Director of Research and Graduate Studies

All successful therapeutic approaches are based on effective communication. This presentation will DEMONSTRATE a procedure that can be very helpful in guiding the researcher to clarify his/her research intent to him/herself, as well as to the intended audience, so that the research efforts are more likely to achieve the intended goal(s).

The first step is to clarify the title through an iterative process that also becomes the last step. Helping the researcher clearly state a title provides focus and minimizes misinterpretations. (This critical first step is a very Rogerian procedure that will be demonstrated.) Next, it must be decided if the Purpose- the WHY the study is needed, is consistent with the Title. (The title may need to be modified to achieve consistency.) This is followed by developing a clear statement of the Problem-the WHAT the researcher wants to do. Again, there must be consistency between the WHY and the WHAT, and they both must align with the Title. The WHAT is going to be done (the problem) dictates the research questions, which in turn dictates the Methodology in the context of the Purpose.

This demonstration will model how one aligns all of these components through an interactive conversational process between the researcher and the methodologist, or the mentor and the mentee, or the client and the evaluator. This process requires active listening skills, not just research methodology skills. Handouts will be provided to help facilitate how to become a statistical therapist.

Wednesday
1:45 - 3:15 p.m.

November 19, 2008
Room: Salon 13

Session 1.1 *Research on Teachers*

Facilitator: Lantry Brockmeier, Valdosta State University

Psychometric Characteristics of the Teacher's High Stakes Testing Survey

Lantry L. Brockmeier, Valdosta State University

Preservice Teacher's Development of Fraction Operations

Jennifer Tobias, University of Central Florida

Measurement of Cultural Awareness and Beliefs of Urban Teachers Using Multilevel Item Response Theory (MLIRT): An Illustration

Prathiba Natesan, Florida International University

Longitudinal Study of Teacher Retention in South Florida: Variables Associated with Retention and Advice from Those Who Stay

Deborah Carlstorm, Teacher Research Institute; Kathleen K. Huie, St. Lucie County Public Schools; Mary Lou Goldberg, Teacher Research Institute

Estimating the School Grade Growth Pattern in Florida: Mixture Modeling with Longitudinal Data

Qian Liu, Florida State University; Stephen M. Nettles, Center for Educational Research and Policy Studies, FSU

Wednesday
1:45 - 3:15 p.m.

November 19, 2008
Room: Salon 14

Session 1.2 *Program Evaluation*

Facilitator: Bonnie Swan, University of Central Florida

Evaluating large and small scale teacher professional development--snapshots from four funded programs

Bonnie Swan, Conrad Katzenmeyer, Jeonghee Huh, Christine Craig, Precious Cristwell, University of Central Florida

Key Evaluation Checklist: Application to Disciplinary and Teen Parenting Programs

Denise Cantalupo, Sarasota County Public Schools; Shelley Robertson, Robertson Consulting Group, Inc.

Recognizing Student Voices: Evaluation of an Upward Bound Saturday Enrichment Academy

Monifa Green Beverly, University of Central Florida

School District's Evaluation of NCLB Supplemental Educational Services (SES)

Julie McLeod, Hillsborough County Public Schools

Determining the impact of a statewide online reading professional development on content area teachers' knowledge and instructional practice in secondary schools

Vicky Zygouris-Coe, Bonnie Swan, University of Central Florida

Wednesday
1:45 - 3:15 p.m.

November 19, 2008
Room: Salon 15

Session 1.3 *Symposium: "The Role of Differential Item Functioning in Validity among Multiple Testing Contexts in Florida"*

Symposium Facilitator: Akihito Kamata, Florida State University

Comparing Logistic Regression and Mantel-Haenszel Approaches in Detecting Uniform DIF in a Large-Scale Assessment

Ariela C. Greenberg, Daryl B. Greenfield, Randall D. Penfield, University of Miami

A DIF Analysis on the Interim Assessment

Karina Gattamorta, Felicia Mallory, Randall D. Penfield, University of Miami

Incorporating CFA, Rasch IRT, and DIF to investigate measurement invariance of a critical thinking disposition questionnaire

Kristina N. Pineau, Mark LaVenita, Laura Hassler Lang, Florida State University

Wednesday
3:30 - 5:00 p.m.

November 19, 2008
Room: Salon 13

Session 2.1 *Issues in Standardized Testing*

Facilitator: Denise Cantalupo, Sarasota County Public Schools

An Investigation of the Relationship between FCAT Reading Achievement Levels, Grade Tested and Learning Gain

Denise Cantalupo, Natalie Roca, Sarasota County Public Schools

School Resources and Performance Gaps in FCAT Mathematics: a Look at Three Large Districts in South Florida

Hong Gao, Jian Gao, Florida State University--FCR-STEM

Achievement and Attitude toward Mathematics in Elementary Education in terms of grade levels

Murat Canli, Celal Bayar University; Ibrahim Avci, Koceeli Department of Education

Citrus County Schools Benchmark Reliability & Validity

Gina Tovina, Citrus County Public Schools

The Effectiveness of Summer Reading Academy (SRA) with 8th Grade Students

Suleyman Olgar, Bulent Kocyigit, Florida State University

Wednesday
3:30 - 5:00 p.m.

November 19, 2008
Room: Salon 14

Session 2.2 *Investigative Research*

Facilitator: Jeffrey Kromrey, University of South Florida

Disattenuation of Correlation Coefficients:

An Empirical Investigation of Point and Interval Estimates

Jeffrey Kromrey, Robert Fay, Aarti P. Bellara, University of South Florida

Validation of Florida's Educator Accomplished Practices Evaluation

Qian Liu, Florida State University

Interval Estimates for Coefficient Alpha Based on Discrete, Ordinal Response Items: A Monte Carlo Study of Eight Methods Proposed in the Literature

Jeanine L. Romano, American University of Sharjah; Jeffrey D. Kromrey, Susan Hibbard, Corina Owens, Heather Scott, University of South Florida

Time to the Doctorate in Education: Discrete-Time Multilevel Hazard Analysis.

Hesborn Wao, University of South Florida

Wednesday
3:30 - 5:00 p.m.

November 19, 2008
Room: Salon 15

Session 2.3 *Research in the Schools*

Facilitator: Kathryn Kennedy, University of Florida

Project based learning with collaborative design and development tools

Kathryn Kennedy, Jeff Boyer, Kara Dawson, Cathy Cavanaugh, University of Florida

Fidelity of Implementation: Strengthen your Research and Results

Laura Cunningham, Nivischi Edwards, University of Central Florida

Examining the Validity of Testing in a Community

Jessica M. Street, Broward Community College; Steven R. Terrell, Maxine Cohen, Martha M. Snyder, Nova Southeastern University;

A Preliminary Development of a Global Education and a Global Citizenship Assessment Instrument: A Discussion of Reliability and Validity Procedures and Estimates

Renita Ferreira, Florida International University

3.0 Florida DOE Session

State of the Art for Assessing Special Populations

Claudia Flowers, University of North Carolina at Charlotte

Moderator: Cornelia Orr

Dr. Flowers is a nationally known research in the alternative assessment area and serves on the Technical Advisory Committee for the Department of Education. The Florida State University graduate students, Hirotaka Fukuhara, Eddy Park, and Harlon Hawthorne, are currently working as interns at the Florida Department of Education Psychometric Office, and will present their latest research relating to English Language Learners.

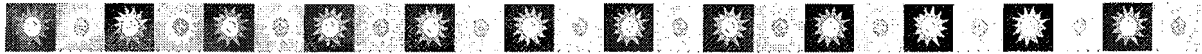

WEDNESDAY
7:00 p.m. – 9:00 p.m.

****WELCOME RECEPTION****

Signature 1

Thursday

November 20, 2008

8:30 - 5:00 p.m.

Registration at Desk 4

9:30 a.m. -11:00 a.m.

Salon 11

Invited Address

USF's Graphicstudio | Institute for Research in Art: Emphasis on "Research"

Noel Smith, Curator of Education

Sarah Howard, Research Assistant

Graphicstudio: University of South Florida

Many people do not readily associate the word "research" with the visual arts. However, in 2008 Graphicstudio celebrates 40 years dedicated to exploring new techniques and aesthetic directions in the making of fine art prints and sculpture multiples. Working in collaboration with distinguished international contemporary artists, Graphicstudio has published over a thousand editions and has invented new techniques and processes and revitalized older ones. Graphicstudio works are in major international public and private collections, including the National Gallery of Art in Washington, D.C. Curator of Education Noel Smith will review Graphicstudio's philosophy and history, while Research Associate Sarah Howard will speak of several of Graphicstudio's most interesting and pivotal research projects.

Thursday

November 20, 2008

11:15 a.m. - 12:45 p.m.

Room: Salon 13

Graduate Student Session

Coordinators: Kuzey Bilir and Karina Gattamorta

Join us for Refreshments and "Meet the Experts" Conversation with:

David Miller, University of Florida

Vicky Zygouris-Coe, University of Central Florida

Yi-Hsin Chen, University of South Florida

John Ferron, University of South Florida

Thursday

November 20, 2008

11:15 a.m. - 12:45 p.m.

Room: Salon 14

Session 6.2 K-12 Research Studies

Facilitator: Roxanne Hughes, Florida State University

The Effects of a Single Sex Science Camp: And its implications for Similar Policies

Roxanne Hughes, Florida State University

***Teacher-child interactions in voluntary pre-kindergarten programs in child care settings:
A critical analysis of barriers and facilitators***

Seunghye Kim, University of Florida

Issues with FCAT SSS Reading Achievement Levels

Suleyman Olgar, Florida State University

AmeriCorps Tutorial Program and its Effects on the Low Performing Students

Bulent Kocyigit, Suleyman Olgar, Florida State University

***Latent class analysis of Florida reading coaches: Categories of coaches based on reported
job tasks***

Derek J. Pasisz, Mark LaVenita, Alysia D. Roehrig, Laura Hassler Lang - Florida State University

Thursday

November 20, 2008

11:15 a.m. - 12:45 p.m.

Room: Salon 15

Session 6.3 Research on Schools and Students

Facilitator: Debbie Hahs-Vaughn, University of Central Florida

Education Dissertation Consistency with Recommended Guidelines of Effect Size Reporting

Debbie L. Hahs-Vaughn, University of Central Florida, Tary Wallace, University of South Florida,
Melinda Stevison, University of Central Florida

***Education Dissertation Consistency with Recommended Guidelines of Measurement
Reporting.***

Tary L. Wallace, University of South Florida Sarasota-Manatee; Debbie L. Hahs-Vaughn, Melinda
Stevison, University of Central Florida

Parental Informed Consent in School-Based Research with Children

Robert F. Dedrick, Robert Fay, University of South Florida

Time to the Doctorate in Education: Students Versus Faculty Perceptions

Hesborn Wao, University of South Florida

Thursday

November 20, 2008

12:45 p.m. - 1:45 p.m.

Lunch on your own

Thursday

November 20, 2008

2:00 p.m. – 3:30 p.m.

Room: Salon 13

Session 7.1 Psychometrics

Facilitator: **Akihito Kamata, Florida State University**

Investigation of the Utility of Two-Level Logistic Regression Mixture DIF Detection Model: A Bayesian Approach

Akihito Kamata, Rae Seon Kim, Mustafa Kuzey Bilir, Florida State University

Item Parameter Estimation for an Item Response Model that Incorporates Response Time

James Ingrisone, Florida State University

A longitudinal study of achievement gap: Gender and ethnicity difference in reading and mathematics progress

Shudong Wang, Pearson; Hong Jiao, University of Maryland; Salih Binici, Florida Department of Education

Application of Testlet Models in Investigations of Content Clustering in Large-Scale Science Assessments

Hong Jiao, University of Maryland; Shudong Wang, Pearson; Salih Binici, Florida Department of Education

Incorporating a Cognitive Model into the Interpretations of Latent Class Analysis for Remedial Instruction

Yi-Hsin Chen, University of South Florida; Yuh-Chyn Leu, National Taipei University of Education

Thursday
2:00 - 3:30 p.m.

November 20, 2008
Room: Salon 14

Session 7.2 Statistics 1

Facilitator: Mary Lieberman, Florida Atlantic University

Using Logistic Regression to Validate Cluster Results

Mary G. Lieberman, John D. Morris, Florida Atlantic University

A Comparison of Four Missing Data Techniques for Estimating Person Scores on Likert-type Scales

Jeffrey Kromrey, Susan T. Hibbard, Patricia Rodriguez de Gil, University of South Florida

A Kernel Resampling Technique to Increase the Accuracy of Estimation from Small Samples

Haiyan Bai, University of Central Florida

Predicting College graduation in STEM Programs: A Special Focus in Engineering and Biology

Hesborn Wao, Reginald Lee, Kathryn Borman, University of South Florida

Session 7.3

Action Research Workshop

Terek Chebbi,
Miami-Dade County Public Schools

**Join Dr. Chebbi for an exceptional action research workshop.
Open to all registered conference attendees at no additional charge.**

BACKGROUND

Action research is a reflective process of progressive problem solving led by individuals working with others in teams or as part of a "community of practice" to improve the way they address issues and solve problems. Action research can also be undertaken by larger organizations or institutions, assisted or guided by professional researchers, with the aim of improving their strategies, practices, and knowledge of the environments within which they practice. (Wikipedia, the free encyclopedia, retrieved January 14, 2008)

GOALS OF THE WORKSHOP

The goals of the Action Research workshop is to give an overview for participants on how to conduct research to **identify** aspects of the educational process that they wish to **enhance**, to identify **skills** to **implement change**, to **investigate** the **results** using a well defined **research method**, and to **communicate** the process as well as the findings to other educators.

At the end of the workshop, participants will:

- be able to describe what is action research and how it differs from "traditional" research;
- understand the process of Action Research;
- learn the processes involved in high quality action research work;
- have an opportunity to practice question development, inquiry and reflection;
- understand what type of research is most appropriate for what type of situation;
- reflect on their practices at their places of work to find areas where there are Opportunities For Improvements (OFI's);
- use the Scientific Research method to address "Practical" issues and problems in order to take Action, hence "Action Research".

Education without the action of "action research" leads to stagnant practice. Action without the research of "action research" leads to random and uninformed change (Sagor, 1992).

Session 7.4 Graduate Student Poster Session

Coordinators: Kuzey Bilir and Karina Gattamorta

Action Learning: A national review of ninth grade academies in the United States. Maria Margarita Fernandez, Florida Atlantic University; Jacqueline K. Daniels, Florida Atlantic University; Stacy Holland, Florida Atlantic University; Scott V. Smith, Florida Atlantic University; Michele Acker-Hocevar, Washington State University; Pat Maslin-Ostrowski, Florida Atlantic University.

Exploring the relationship between counseling students' self-efficacy and psychological distress. Jonathan H. Ohrtm, University of Central Florida; Kara P. Ieva, University of Central Florida; Jacqueline Swank, University of Central Florida.

Morphological Awareness and the Development of Reading Proficiency in Second-Language Learner's: A Research Synthes. Miriam G. Lipsky, University of Miami; Amanda Goodwin, University of Miami

Universal Design for Learning(UDL) during content area lesson planning for inclusion. Sara Aronin, University of Central Florida.

Can morphological interventions improve reading outcomes for typically achieving children and/or children with reading disabilities? Amanda P. Goodwin, University of Miami; Miriam G. Lipsky, Maria Carlo, University of Miami.

Academic Achievement and Traumatic Stress among lower SES Primary School Students. Rachael D. Goodman, University of Florida; Cirecie A. West-Olatunji, University of Florida.

The relation between principal login to the Progress Monitoring and Reporting Network and student achievement. Derek J. Pasisz, Florida State University; Meghan V. Hauptli, Florida State University; Alysia D. Roehrig, Florida State University Laura Hassler Lang, Florida State University.

A SAS program for conducting randomization tests of Multiple-Baseline data. Joel Wao, University of South Florida.

Exploring Academic Self-Efficacy Sources and Perceived Student Difficulty of Mathematics: Examining by gender and ethnicity. Gabriel Quintana, University of Miami.

Exploring the applicability of a model of altruistic behavior for counseling students: A qualitative study. Jacqueline Swank, University of Central Florida; Jonathan H. Ohrt, University of Central Florida; Kara P. Ieva, University of Central Florida.

Locate DIF-free items as Anchors using generalized nonlinear mixed model. Qian Liu, Florida State University.

Preliminary Evaluation of the Florida Reading Initiative. Eric M. Christesen, Florida State University; Derek J. Pasisz, Florida State University; Alysia D. Roehrig, Florida State University.

A randomization test SAS Program for making treatment effect inferences for extensions and variations of ABAB Single-Case Experimental Design. Patricia Rodriguez de Gil, University of South Florida; John Ferron, University of South Florida.

From "Pipeline" to "Pathway": A critical understanding of the undergraduate retention. Cynthia A. Grace, University of South Florida; Cassandra L. Workman, University of South Florida; Jason Miller, University of South Florida; Kathryn Borman, University of South Florida.

How does an instructional unit on whole number concepts and operations situated in base-8 impact the conceptual understanding of individual prospective elementary teachers? Farshid Safi, University of Central Florida

A Post Structural investigation of clinical supervision in the helping professionals. David Cavalleri, University of Florida

Morphological Awareness and the Development of Reading Proficiency in Second-Language Learner's: A Research Synthesis. Miriam G. Lipsky, University of Miami; Amanda Goodwin, University of Miami.

Universal Design for Learning(UDL) during content area lesson planning for inclusion. Sara Aronin, University of Central Florida.

Note: Posters will remain on display until 5 p.m.

Thursday

3:45 - 5:15 p.m.

November 20, 2008

Room: Salon 13

Session 8.1

FATA Sponsored Session

Chairperson:

Dr. Christine Kerstyn, President, Florida Association of Test Administrators

Thursday
3:45 - 5:15 p.m.

November 20, 2008
Room: Salon 14

Session 8.2 Education and Technology

Facilitator: Ann Barron, University of South Florida

Trends in Elementary School Websites: Content, Techniques, Functions and Security

Ann E. Barron, Tina Hohlfeld, University of South Florida; Karen Ivers, University of California, Fullerton

Reaching the hard to reach: Using a technology-based singing intervention with struggling readers in alternative education and juvenile justice sites. Can it make a difference?

Susan Homan, Robert Dedrick, Cynthia Calderone, University of South Florida; Anne Chatfield, Hillsborough County Schools

Evaluation of the Florida Digital Educator (FDE) Program

Tina N. Hohlfeld, Ann E. Barron, University of South Florida; Kate Kemker, Florida Department of Education

Pilot Test and Evaluation of Florida's Student Tool for Technology Literacy (ST2L)

Ann E. Barron, Tina N. Hohlfeld, University of South Florida;
Albert Ritzhaupt, University of North Carolina: Wilmington

Women in educational technology: Content analysis of AACE journals 2004-2007

Feng Liu, Kathryn Kennedy, Kara Dawson, Cathy Cavanaugh, University of Florida

Thursday

November 20, 2008

3:45 - 5:15 p.m.

Room: Salon 15

Session 8.3 Education, Ethnicity, and Culture

Facilitator: Kathy Borman, University of South Florida

A Multilevel Examination of Florida's Educational Outcomes: Race Matters.

Kathryn Borman, Reginal Lee, Hesborn Wao, University of South Florida

The Impact of Reading Instructional Methodology on Student Achievement of Black Males on FCAT Norm-Referenced Tests

Deedara Hicks, Florida Atlantic University

The Impact of African American Parenting Behaviors on the Academic Achievement of their Primary School Children

Cirecie A. West-Olatunji, Rachael D. Goodman, Walter Leite, Laura Reid, Tiffany D. Sanders, University of Florida

Return to Korean Higher Education: Regarding Gender, Year of Schooling, College Quality and Major

Heesook Lee, Jae Young Chung, Florida State University

The Influence of Engineering Departmental Culture on Undergraduate Retention

Hesborn Wao, Bridget A. Cotner, Cassandra Workman, Reginald Lee, Cynthia Grace, Kathryn Borman, University of South Florida

EVENING RECEPTION

5:30 p.m. – 7:30 p.m.

Signature 2

Sponsored by:

Educational Testing Service

Meet our Sponsors:

George Powell -- Vice President and Chief Operating Officer, K-12 Assessments

Alice Lindsay - Director, Florida and the Islands Regional Comprehensive Center

Valerie Link - Manager, Psychometrics



Friday

November 21, 2008

8:30 - 11:00 a.m.

Registration @ Desk 4

Friday

8:30 - 11:00 a.m.

Room: Salon 13

Session 9.1 Statistics II

Facilitator: John Ferron, University of South Florida

***Estimating Individual Effects from Multiple-Baseline Data:
A Monte Carlo Study of Empirical Bayes***

John Ferron, Jennie L. Farmer, Corina Owens, University of South Florida

Evaluation of Method Effects of Internalizing Behavioral Problems

Ying Zhang, Yanyun Yang, Florida State University

***Fixed or Random Effects, That is the Question: The Process and Impact of Model Selection on
Meta-Analysis Results***

Gianna Rendina-Gobioff, Professional Testing Inc; Jeffrey D. Kromrey, Kevin Coughlin,
University of South Florida

***Improving the Sampling Approach to Assemble Polyomous Items Based on the Generalized
Partial Credit Model***

Haiyan Wu, Pei-Hua Chen, Florida State University

Modeling timed tests and calibrating item parameters

Soo Jeong Ingrisone, Florida State University

Friday
8:30 - 11:00 a.m.

November 21, 2008
Room: Salon 14

Session 9.2 Research on Student Achievement 1

Facilitator: Robert Dedrick, University of South Florida

Advancing the Research Agenda of Mentoring in Doctoral Education:

Robert F. Dedrick, Corina M. Owens, University of South Florida

An Investigation into the Efficacy of Personalized Study Guides on Student Mastery of State Standards

Alice Boyce, Steven Grossman, Hezel Associates; Andrew Sokatch, The Grow Network

The Impact of Mobility on the Efficacy of a Three-year Science Intervention

Anne Corinne Huggins, Randall Penfield, Okhee Lee, Jaime Maerten-Rivera, University of Miami

Influence of self-perception on English language learner success

Mitch Sullivan, Aysegul Bayraktar, Florida State University

Assessment of Culturally Competent Practice that Impacts Student Achievement in Schools

Donna Elam, Jeffrey D. Kromrey, Emily Shaffer, Janice Sullivan, Tina Holfeld, Aarti Bellara, University of South Florida

Friday

November 21, 2008

Session 9.3 Research on Student Achievement II

Room: Salon 15

Facilitator: Reginald Lee, University of South Florida

Climate Perceptions Among Engineering Students: An Application of rwg Statistic on Assessing Agreement Among Raters

Reginald Lee, Hesborn Wao, Cassandra Workman, Cynthia Grace, University of South Florida; Cheri Ostroff, University of Maryland; Kathryn Borman, University of South Florida

Meta-Analysis for Algorithm Development

Esra Kocyigit, Betsy J. Becker, Florida State University

A Meta-Analysis of Charter School Effects on Student Achievement

Jae Young Chung, In-Soo Shin, Florida State University

Between-study dependence in meta-analysis

In-Soo Shin, Betsy J. Becker, Florida State University

Student Preparation and Curriculum: Challenges and Factors for Success in STEM Programs

Hesborn Wao, Rebekah Heppner, Reginald Lee, Kathryn Borman, University of South Florida

Friday
10:15-11:30 a.m.

November 21, 2008
Room: Salon 11

Session 10.0: Keynote Address

***Managing and Leading in the Midst of Chaos:
Lessons Learned From New Orleans***

Luis Miron
Loyola University

Luis Miron, who has studied New Orleans education reform for two decades, will present an overview of the post Katrina recovery strategies for the New Orleans public schools.

In the presentation Dr. Miron will briefly highlight the legislation and policy precedents giving rise to the unprecedented state take over of 107 public schools in the state, the outsourcing of the school district's finances to a private accounting firm, and the surge of charter schools in the city.

The latter accounts for approximately 70% of the market share in the New Orleans public schools.

The bulk of this keynote address will center in the management tensions between the Recovery School District (which operates roughly 1/2 of all the schools, including state governed charters) and the loose federation of quasi private schools, including new charters and selective admission magnet schools. The presentation will conclude with a list of pros and cons to the apparent effort in Louisiana and elsewhere to privatize public education.

Friday
12:00-1:30 p.m.

November 21, 2008
Room: Salons 1 & 2

**FERA Luncheon
Business Meeting and Presentation of Awards**

Sponsored by:

Pearson

Meet our Sponsors:

**Lisa J. Carter
Michael Keaton**

1:30- 2:30 p.m.

FERA Executive Board Meeting

Salon 24

2008 FERA Executive Committee

Past President	Natalie Roca, Sarasota County Public Schools
President	Akihito Kamata, Florida State University
President Elect	Wendy Dickinson, Ringling College of Art & Design
Secretary	Sam Whitten, Hillsborough County Schools
Treasurer	Denise Cantalupo, Sarasota County Public Schools
Director	Frank Gilbert, Orange County Schools
Director	Jan Morpew, Florida Dept. of Education
Director	Abbas Tashakkori, Florida International University

2008 FERA Annual Meeting Program Committees

Annual Meeting Chairperson	Wendy Dickinson, Ringling College of Art & Design
Local Arrangements	Debbie Hahs-Vaughn, University of Central Florida
Sponsors and Vendors	Natalie Roca, Duval County Public Schools
Social Arrangement	Donna Buckner, Polk County Public County Schools
Paper Proposal Review	Salih Binici, Florida Department of Education
Distinguished Paper Award	David Miller, University of Florida Jeff Miller, University of Florida
Awards and Recognition	Kathy Dailey, Polk County Public Schools Ron Dailey, Hillsborough County Public Schools
Evaluation Committee	Denise Cantalupo, Sarasota County Public Schools
Best Graduate student "Poster" Award	Kuzey Bilir, Florida State University Karina A. Gattamorta, University of Miami
Educational Researcher of the Year	Yanyun Yang, Florida State University
Russell Kropp Award	Bruce W. Hall, University of South Florida Brenda Bartholomew, Consultant John Hilderbrand, Hillsborough County Public schools
Nominations	Jerry Levitt, Miami-Dade County Public Schools

2008 Standing Committee Chairs

Newsletter Editor	Bonnie Swan, University of Central Florida
Website/Newsletter	Lisa Adkins, University of South Florida
Graduate Student Coordinator(s)	Kuzey Bilir, Florida State University. Karina A. Gattamorta, University of Miami
Publications: FERJ	Jeffrey Kromrey, University of South Florida
Professional	Mark Shermis, University of Florida

Presidents of FERA

Year	President	Year	President
1958-59	Russell Kropp	1985-86	Bill Piotrowski
1959-60	Walter Durost	1986-87	Bruce Hall
1960-61	Robert N. Willis	1987-88	Patricia W. Kees
1961-62	John Demming	1988-89	Constance Bergquist
1962-63	Annie Ward	1989-90	Jackson K. McAfee
1963-64	Howard W. Stoker	1990-91	Lou Carey
1964-65	Karen A. Strattan	1991-92	Jayne Hartman
1965-66	John T. Kirby	1992-93	Cornelia S. Orr
1966-67	Richard R. Burnette	1993-94	Marc Baron
1967-68	Edward Caldwell	1994-95	Janet B. Hanson
1968-69	Fred Stuart	1995-96	Jan Schwartz
1969-70	John E. Dobbin	1996-97	Dianne Buhr
1970-71-	Vynce A. Hines	1997-98	Lee Baldwin
1971-72	Jacob Beard	1998-99	Dan Morris
1972-73	Willard Nelson	1999-00	Cynthia Parshall
1973-74	Janice Smith	2000-01	Brenda Bartholomew
1974-75	John Follman	2001-02	Richard Tate
1975-76	Rick Nations	2002-03	Jerry Levitt
1976-77	Richard Jaeger	2003-04	Bruce Hall
1978-79	James Swanson	2004-05	Madeline Barbery
1979-80	Paul Gallagher	2005-06	David Miller
1980	Don Lambert *	2006-07	Natalie Roca
1980-81	Annie Ward *	2007-08	Akihito Kamata
1981-82	John Hilderbrand	2008-09	Wendy Dickinson
1982-83	Russell Kropp		
1983-84	Jean Jolly		
1984-85	Chuck Dziuban		

*Don Lambert was installed in January 1980. Annie Ward was installed in November 1980.

2008 First Author Presenters List

Haiyan Ba , hbai@mail.ucf.edu
Ann E. Barron , Barron@tempest.coedu.usf.edu
Moriifa Green Beverly, mbeverly@mail.ucf.edu
Kathryn Borman, kborman813@aol.com
Lantry Brockmeier, lantry.brockmeier@comcast.net
Alice Boyce, Alice@hezel.com
Murat Canli, murcanli@yahoo.com
Denise Cantalupo
denise_cantalupo@sarasota.k12.fl.us
Deborah Earley Carlstrom dcarlstrom@bellsouth.net
David Cavalleri, cavaller@ufl.edu
Yi-Hsin Chen, YChen@coedu.usf.edu
Jae Young Chung, jchung@fsu.edu
Laura Cunningham, l_k_cunningham@hotmail.com
Robert F. Dedrick, Dedrick@tempest.coedu.usf.edu
Donna Elam, Elam@coedu.usf.edu
Renita Ferreira, rferr008@fiu.edu
John Ferron , Ferron@tempest.coedu.usf.edu
Hong Gao, hgao@lsi.fsu.edu
Karina Gattamorta, kgattamorta@miami.edu
Ariela C. Greenberg, a.greenberg2@umiami.edu
Debbie Hahs-Vaughn, dhahs@mail.ucf.edu
Deedara Hicks , dhah35@aol.com
Esra Kocyigit, ek06@fsu.edu
Tina N. Hohlfeld, thohlfeld@coedu.usf.edu
Susan Homan, homan@tempest.coedu.usf.edu
Anne Corinne Huggins, corinnehuggins@gmail.com
Roxanne Hughes, rmh05e@fsu.edu
Jason Hutchens, JHutchens@darden.com
Soo Jeong Ingrisone, singrisone@yahoo.com
James Ingrisone , ingrisone@yahoo.com
Hong Jiao, hjiao@umd.edu
Akihito Kamata, kamata@mail.coe.fsu.edu
Kathryn Kennedy, kkennedy78@gmail.com
Seunghee Kim , seuhkim@ufl.edu
Bulent Kocyigit, bbk2216@fsu.edu
Jeff Kromrey, kromrey@tempest.coedu.usf.edu
Heesook Lee, jchung@fsu.edu
Reginald Lee, rlee@cas.usf.edu
Mary G. Lieberman, mliberm@fau.edu
Feng Liu, martinlf@ufl.edu
Qian Liu, ql03@fsu.edu
Julie McLeod, Julie.McLeod@sdhc.k12.fl.us
Prathiba Natesan, prathibachaj@gmail.com
Suleyman Olgar, solgar@fsu.edu
Derek J. Pasisz, derekpasisz@comcast.net
Kristina N. Pineau, kpineau@fsu.edu
Gianna Rendina-Gobioff, grendina@proftesting.com
Jeanine L. Romano, jromano@aus.edu
In-Soo Shin, iss02c@fsu.edu
Jessica M. Street, jessicastreet@hotmail.com
Mitch Sullivan, sullmitch@yahoo.com
Jennifer M. Tobias, jtobias@mail.ucf.edu
Gina Tovine, TovineG@citrus.k12.fl.us
Tary L. Wallace, twallace@sar.usf.edu
Haiyan Wu, wuhaiyan329@yahoo.com
Vicky Zygouris-Coe , vzygouri@mail.ucf.edu

2008 Paper Proposal Reviewers

Haiyan Bai, University of Central Florida
Betsy Jane Becker, Florida State University
Monifa Green Beverly, University of Central Florida
Mustafa Kuzey Bilir, Florida State University
Kathryn Borman, University of South Florida
Lantry L. Brockmeier, Valdosta State University
Cynthia Calderone, University of South Florida
Denise Cantalupo, Sarasota County Public Schools
Tina Cash, Florida International
Yi-Hsin Chen, University of South Florida
Steven Condly, HSA Learning & Performance Solutions
Bridget Cotner, University of South Florida
Kevin Coughlin, University of South Florida
Ron Dailey, Hillsborough County Public Schools
Jennie P Dautermann, Florida International
Robert F. Dedrick, University of South Florida
Fawzy Ebrahim, Florida Atlantic University
Stewart Elizondo, University of Florida
Meichu Fan, Pearson
Renita Ferreira, Florida International
John Ferron, University of South Florida
Sandra Fletcher, Florida International
Laura Ford, HumRRO
Lianhong Gao, Florida International
Hong Gao, Florida State University
Karina Gattamorta, University of Miami
Roger Geertz Gonzalez, Florida International
Rachael Goodman, University of Florida
Marilyn Gordon, Florida International
Ariela C. Greenberg, University of Miami
Debbie Hahs-Vaughn, University of Central Florida
Deedara Hicks, Florida Atlantic University
R. Gene Hoffman, HumRRO
Tina N. Hohlfeld, University of South Florida
Susan Homan, University of South Florida
Anne Corinne Huggins, University of Miami
Jason Hutchens, University of Central Florida
Cynthia Moredock Januszka, Florida International
Hong Jiao, University of Maryland
Sema Kalaian, Eastern Michigan University
Ayhan Karaman, Florida State University
Rafa M. Kasim, Kent State University
Kathryn Kennedy, University of Florida
ChanMin Kim, Florida State University
Jeffrey D. Kromrey, University of South Florida
Reginald Lee, University of South Florida
Jeongmin Lee, Florida State University
Mary G. Lieberman, Florida Atlantic University
Feng Liu, The University of Florida
Qian Liu, Florida State University
Teresa Lucas, Florida International
Ghazwan A. Lutfi, Florida A & M University
Peggy Mandel, Florida International
Pat Maslin-Ostrowski, Florida Atlantic University
Julie McLeod, Hillsborough County Public Schools
David Miller, University of Florida
Dan Morris, Florida Atlantic University
Prathiba Natesan, Florida International
Yvette M. Nemeth, HumRRO
Ann Nevin, Florida International
Sangwook Park, Florida State University
Derek Pasisz, Florida State University
Jeanine Romano, American University of Sharjah
Fay Roseman, Barry University
Patricia Salahuddin, Florida International

Sally Shay, Miami-Dade County Public Schools
Mark Shermis, University of Florida

Proposal Reviewers (continued)

In-Soo Shin, Florida State University
Patricia Simmons, Hillsborough County Public Schools
Andrea Sinclair, Human Resources Research Org.
Mitchell Sullivan, Florida State University
Abbas Tashakkori, Florida International University
Steve Terrell, Nova Southeastern University
Jennifer Tobias, University of Central Florida

Gina Tovine, Citrus County Schools

Ahmet Turhan, Pearson
Tary Wallace, University of South Florida
Shudong Wang, Pearson
Hesborn Wao, University of South Florida
Rangsun Wiboonuppatum, UNICEF
Yanyun Yang, Florida State University
Maryam Soltan Zadeh, Florida International

Honorary Members of FERA

H. H. Remers	1966	Annie Ward	1984
June Hopper	1974	Russell Kropp	1985
Roger T. Lennon	1975	Bill Myers	1985
William H. Angoff	1975	Jake Beard	1997
George Loiselle	1976	Rick Nations	1997
Hazen Curtis	1976	Jack McAfee	1998
Vynce Hines	1981	Jim Swanson	2000
John Espey	1981	Bill Castine	2001
Walter Durost	1981	Chuck Dzuiban	2005
Howard Stoker	1983	Bruce Hall	2007

*Many thanks to our
2008 Annual Meeting Sponsors*

Educational Testing Service

Florida State University, College of Education

Pearson

Special thanks

Lee Baldwin, Orange County Public Schools

Ron Blocker, Superintendent, Orange County Public Schools

Lisa Carter, Pearson

**Marcy Driscoll, Dean
College of Education, Florida State University**

Laura Plemenik, Educational Testing Service