

# Florida Educational Research Association

*55<sup>th</sup> Annual Meeting*



*Rosen Centre Hotel*

**Orlando, Florida**

**November 17-19, 2010**

# Hotel Floor Plan

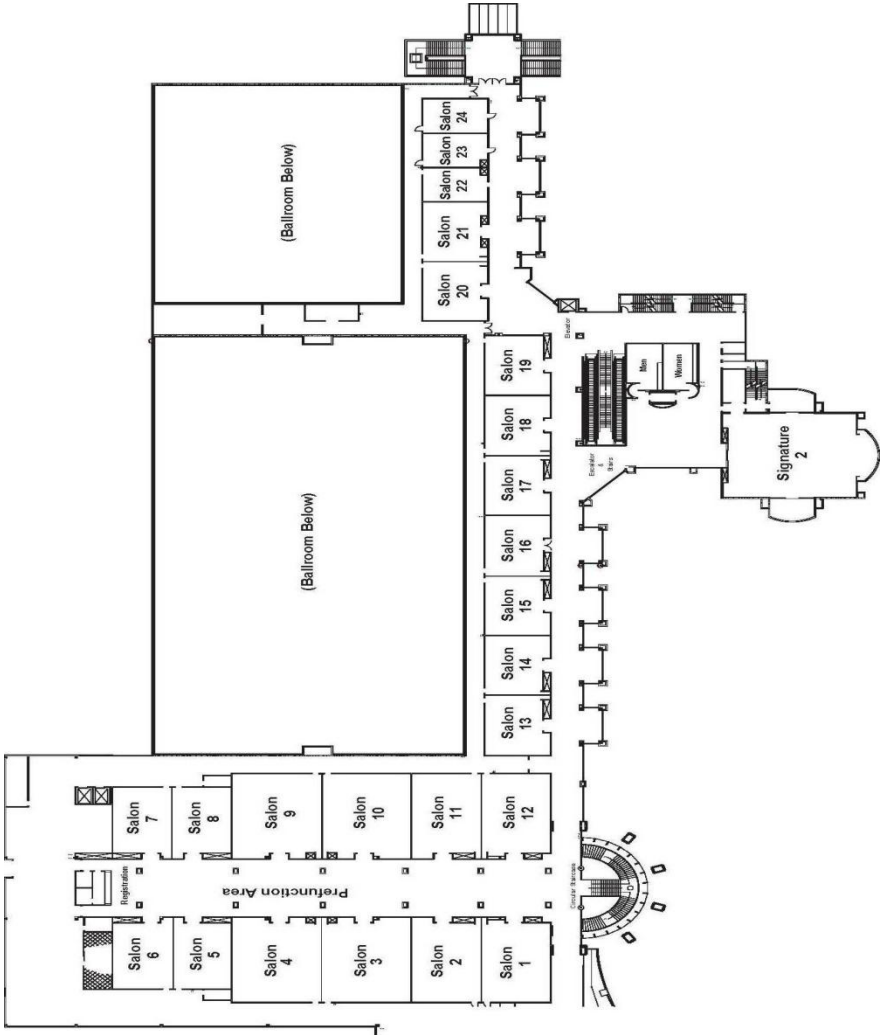

**Featured Address**

**12:00 – 1:30 PM**

**Signature 2**

- **Measuring Growth or  
Just Growing Measurement?**

How an Ipsative Model for  
Measuring Student Growth  
Could Benefit Students, Schools  
and Improve Decision Making

Dr. James Ashby  
Vice-President for Research  
and Chief of Psychometrics. Core K12

A substantive educational policy issue at federal, state, and district levels focuses on the design and use of growth models in conjunction with accountability systems and teacher evaluation. Often growth modeling is accomplished with high stakes, summative tests rather than with formative or interim assessments. Innovative approaches in growth modeling show potential for use of varied assessments in supporting student growth, communicating student performance to various constituencies, improving instruction, and evaluating teachers more equitably.

Dr. Ashby recently joined CORE K12 as Vice-President for Research and Chief of Psychometrics. In addition to his background in educational psychology, he has held leadership roles with assessment, research, and accountability in school districts, including Plano, TX and Knox County, TN. His current research focus is in the area of growth modeling.

# Wednesday November 17

## 2.1 Assessment Programs

1:45 - 3:15 PM Salon 19

- **Implementation of a Cohesive Interim Assessment System in a Middle Size District**  
Paul Felsch , Leon County Public Schools  
Linda Dean, Leon County Public Schools
- **Development and Assessment of an Instrument for the Evaluation of Volunteer Drivers for the Tampa Meals on Wheels Program.**  
Richard F. Brummer, University of South Florida  
Claudia Güerere, University of South Florida

## 2.2 Measurement Instruments **1:45 - 3:15 PM Salon 20**

- **A Psychometric Review of Instruments for Student Evaluations of Distance Education Instruction**  
Elizabeth Shaunessy, University of South Florida  
Robert Dedrick, University of South Florida  
Aarti Bellara, University of South Florida  
Connie Walker, University of South Florida  
Eun Kung Baek, University of South Florida  
Shelley Stewart, University of South Florida
- **The Development of An Instrument Based on Theory by Dr. Cy Houle; A Validation Attempt.**  
Claudia Güerere, University of South Florida  
Christy Rhodes, University of South Florida
- **An Empirical Comparison of Four Missing Data Techniques for Estimating Person Scores on Likert-type Scales**  
Patricia Rodriguez de Gil, University of South Florida  
Jeffrey D. Kromrey, University South Florida

# Wednesday November 17

## 2.3 Technology and Learning **1:45 - 3:15 PM Salon21**

- **Combining Social Network Analysis with Responsive Evaluation to Study a Growth in a Collaboration Over Time—A Situated Perspective for Improving Florida Nursing Education**  
Bonnie Swan, University of Central Florida  
Jaime Godek -- University of Central Florida
- **Instructional Technology Course Redesign: Iteration One**  
Beth E.Jordan, University of South Florida  
Oma Baliram Singh, University of South Florida  
Michelle Stewart, University of South Florida  
Cameron Spears, University of South Florida  
Tina N. Hohlfeld, University of South Florida
- **Technology Use in Two Florida Career Academies: A Qualitative Study**  
Margaret Allsopp, University of South Florida
- **Groups 2.0: A model for Conducting Successful Group Projects Online Using Web 2.0 Technologies**  
Shelley Stewart, University of South Florida

# Wednesday November 17

## 3.1 Symposium

3:30 – 5:00 PM

Salon 19

- **Pre and Post: A View of Florida's Third Grade Retention Policy**  
Danielle V. Dennis, University of South Florida  
Diane C. Kroeger, University of South Florida  
James Welsh, University of South Florida  
Richard C. Brummer, University of South Florida  
Eun Kyeng Baek, University of South Florida

## 3.2 School Issues

3:30 – 5:00 PM

Salon 20

- **Examination of Teacher Views About the Role of Constructivist Program That Makes Literate Students for Science and Technology**  
Yakup DOGAN, Florida State University  
Esra Kocyigit, Florida State University  
Oguzcan Cig, Florida State University
- **Florida Middle School Principals Acknowledge the Seriousness of Student Cyberbullying**  
Margaret C. Gardner, University of Central Florida  
Debbie Hahs-Vaughn, University of Central Florida  
Rosemarye Taylor, University of Central Florida
- **Happy Learning: An Assessment of Florida's Super Scientist Program**  
Jennifer J. Vogel-Walcutt, University of Central Florida  
Mitchell H. Vogel, Evens Elementary School

# Wednesday November 17

## 3.3 Research on STEM

3:30 – 5:00 PM

Salon 21

- **Rigorous and Accelerated High School Mathematics and Science Course Taking: Pathways to STEM Careers for Women**  
Patricia Rodriguez de Gil, University of South Florida  
Reginald S. Lee, University South Florida  
Rheta E. Lanehart, University South Florida  
Kathryn M. Borman, University South Florida
- **Effect of STEM Career Academies on High School Math and Science Course Taking: A Transcript Study of the 12<sup>th</sup> Grade 2006 Cohort**  
Patricia Rodriguez de Gil, University of South Florida  
Reginald S. Lee, University South Florida  
Rheta E. Lanehart, University South Florida  
Kathryn M. Borman, University South Florida
- **The Role of Living and Learning Communities in Women’s College STEM Decisions**  
Roxanne Hughes, Florida State University
- **What are the Factors Affecting Women’s Persistence in STEM?**  
Roxanne Hughes, Florida State University



## 4.0 DOE Sponsored Session 5:15 – 6:45 PM Signature 2

### Scaling, Linking, and Equating in Large Scale Assessment

**Moderator: Salih Binici**

## 4.0 DOE Sponsored Session 5:15 – 6:45 PM Signature 2

### Featuring:

#### **Dr. Neil J. Dorans**

Distinguished Presidential Appointee, Educational Testing Service.

*During Dr. Dorans' 27 years at ETS, he has had primary responsibility for the statistical work associated with the AP®, PSAT/NMSQT®, and SAT® exams.*

#### **Dr. Walter (Denny) Way**

Vice President of Psychometric and Research Services  
Pearson Educational Measurement.

*Dr. Way's primary research interests include computerized testing, item response theory, and large scale assessment.*

#### **Dr. Mark Reckase**

Distinguished Professor, Measurement and Quantitative  
Methods, Michigan State University

*Dr. Reckase specializes in the development of educational and psychological tests, educational policy related to testing, and the psychometric theory that supports the assessment of cognitive skills and content knowledge.*

Wednesday November 17

# **Welcome Reception:**

Pool Balcony **7:00 – 8:30 Pool Balcony**

Sponsored by

**E2020**

Meet our Sponsors

Janis Williams

and

**Pearson Assessment for Learning**

Meet our Sponsors

Lisa Carter

Andy Krazit

(Backup location Salon 16)

## 5.1 Teacher and Principal Prep **8:45 - 10:15 PM Salon 19**

- **Pre-service Teachers' Attitudes Toward the Florida Comprehensive Assessment Test (FCAT)**  
Jacquelin W. Cocke, Florida State University
- **Comparing the Effects of Context Based vs. Non-context Based Problems in a Mathematics Methods Course on Pre-Service Teacher Math Anxiety**  
Leslie Nisbet, Florida International University  
Maria L. Fernandez, Florida International University  
Roxanne Molina, Florida International University
- **The Effect of Microteaching Lesson Study on Elementary Pre-service Teacher Content and Pedagogical Content Knowledge**  
Roxanne Molina, Florida International University  
Leslie Nisbet , Florida International University  
Maria L. Fernandez, Florida International University
- **Principal Preparation and Development: Learning to Lead Within an Action Learning Group**  
Pat Maslin-Ostrowski, Florida Atlantic University  
Michele Acker-Hocevar, Washington State University  
Meredith Mountford, Florida Atlantic University  
Judith T. Garrard , Florida Atlantic University  
Joyce Krzemienski, Florida Atlantic University

## 5.2 Science Instructions

8:45 - 10:15 PM

Salon 20

- **Comparative Case Study of Two Informal Science Learning Programs:Focusing on Gender**  
Roxanne Hughes, Florida State University  
Kristen Molyneaux, University of Wisconsin, Madison  
Pat Dixon, Florida State University/National High  
Magnetic Field Laboratory
- **Investigating the Amazing You Through Technology: Evaluation of informal science Learning Within the Museum Environment**  
Wendy D. Dickinson, Ringling College of Art and Design  
Bruce W. Hall, University of South Florida
- **A Mixed Methods Analysis of a Professional Development Model for Integrating Technology into the Music Classroom**  
Michael S. Zelenak, University of South Florida

## 5.3: Mathematics Instruction **8:45 - 10:15 PM** **Salon 21**

- **Relations Between Students Reading and Mathematics Achievements From a large scale assessment: A Multivariate Latent Growth Curve Approach**  
Qian Liu, Florida State University  
Yanyun Yang, Florida State University
- **Analysis of an Original Research Hypothesis and Data: An Application of Growth Mixture Modeling Using Math Achievement Data From a Large-Scale Assessment.**  
Fatih Orcan, Florida State University  
Esra Kocyigit, Florida State University
- **Cognitive Preference Test in Calculus (CPTC)**  
Erhan Selcuk Haciomeroglu, University of Central Florida  
Eric Chicken, Florida State University  
Robert Schoen, Florida State University
- **Statistical Literacy as a Function of Course Format**  
Kelly Morehead, University of Central Florida,  
Debbie Hahs-Vaughn, University of Central Florida

# Thursday November 18

## 6.0 Invited Speakers:

10:30 AM – 12:00 PM Signature 2

**Robert Meyer**, Research Professor at the Wisconsin Center for Education Research (WCER). He is the Director of the Value-Added Research Center (VARC) and known for his research on value-added modeling and evaluation methods. Over the last decade and a half, Meyer has worked closely with districts and states to develop and apply innovative statistical methods.

**Damian Betebenner**, Associate at The National Center for the Improvement of Educational Assessment in Dover, New Hampshire. His areas of specialization include applied statistics, particularly with regard to large scale data analysis. His current research interests center around longitudinal data analysis, specifically with regard to state and federal performance mandates.

## 7.0 Graduate Student Luncheon

12:15 – 1:15 PM Salon 20

### F.E.R.A. Graduate Student Business Meeting

Luncheon Sponsored by Dr. Bruce Hall

---

#### Graduate Student Coordinators:

Kristina N. LaVenía & Corine Huggins

## 8.0 Poster Session **1:30 - 3:15 PM Salon 21**

- **A Multidimensional Approach to Understanding the Implications of Religion/Spirituality on Adolescent Self-Esteem and Loneliness**  
Greer Findura University of Miami
- **Differential Item Functioning for Minority Principals on a Math Content Knowledge Test**  
Anabelle Reta Sanchez Florida State University  
Frederick Sakon Florida State University
- **Adult Cognitive Decline: Research on Origins and Compensation Methods**  
Lori A. Kress University of Central Florida
- **Comparison of Standardized Mean Differences from Analysis of Variance Designs**  
Sanghyun Jeon
- **African American College Student's Perceived Risk of Contracting HIV**  
Chika Ofuani Florida A&M  
Elizabeth Gray Florida A&M
- **The Role of Cognitive and Metacognitive Reading Comprehension Strategies in the Reading and Interpretation of Mathematical Problem Solving Text Applications: Reading Clinicians' Perceptions of Domain Relevance and Elementary Students' Cognitive Strategy Use**  
Taylar Clements University of Central Florida

# Thursday November 18

## 8.0 Poster Session, continued **1:30 - 3:15 PM Salon 21**

- **A Simulation of Dependent Outcomes in Multiple-Endpoint Meta-analyses Using Q-statistics and Rejection Rates**

Christopher Thompson Florida State University

- **Investigating Allocation Patterns in Teacher Bonuses: Florida's School Recognition Program**

Meghan Hauptli Florida State University

Brooke Soden-Hensler Florida State University

Laura B. Lang Florida State University

- **The Importance of Self-Regulation for Students with Poor Academics**

Padma Balmick University of Central Florida

### A Summary of Results from the Florida Online Reading Professional Development (FOR-PD)

Cynthia Cassagnol University of Central Florida

Vicky Zygouris-Coe University of Central Florida

Bonnie Swan University of Central Florida

- **A Summary of Results from the Florida Online Reading Professional Development (FOR-PD)**

Cynthia Cassagnol University of Central Florida

Vicky Zygouris-Coe University of Central Florida

Bonnie Swan University of Central Florida



# Thursday November 18

**Note: Posters will be on display until 5:15 pm**

---

## 8.1 Robert Meyer Breakout

**1:30 - 3:15 PM Salon 19**

- **Robert Meyer**, Research Professor at the Wisconsin Center for Education Research (WCER)

## 8.2 Issues in Assessment

**1:30 - 3:15 PM Salon 20**

- **A Comparison of Modern Longitudinal Change Models with an Examination of Alternative Error Covariance Structures**  
Jaime Maerten-Rivera, University of Miami  
Nicholas Myers, University of Miami
- **Comparison of Latent Growth Models with Different Time Coding Strategies in the Presence of Inter-Individually Varying Time Points of Measurement**  
Burak Aydin, University of Florida  
Nicholas Myers, University of Miami  
James Algina, University of Florida
- **Comparing Cross Validated Classification Accuracies for Alternate Predictor Variable Weighting Algorithms**  
Mary G. Lieberman, Florida Atlantic University  
John D. Morris, Florida Atlantic University
- **A Comparison of Logistic Regression Models for DIF Detection In Polytomous Items: The Effect of Small Sample Sizes And Non-Normality of Ability Distributions**  
Yasemin Kaya, University of Florida  
Walter L. Leite, University of Florida

# Thursday November 18

M. David Miller, University of Florida

## 8.3 Students with Special Needs

1:30 - 3:15 PM Salon 21

- **Assessing the Effectiveness of a Parent Education Program for Children with Disabilities**  
Haiyan Bai, University of Central Florida  
Caroline Marrett, University of Central Florida  
Donna Leinsing, UCF Academy, University of Central Florida
- **The Impact on Teachers' Qualifications and Parents' Characteristics and Parental Learning Activities on Young, Immigrant Children's School Readiness**  
Young-Hee Park, Florida State University  
Jin Koo -- Florida State University
- **Job Satisfaction and Intention to Leave in Korean Childcare Teachers**  
Sung-on Hwang, Florida State University  
Young-Hee Park -- Florida State University
- **Growth Mixture Model: Identification of Latent Subpopulations for Vocabulary Development Trajectory**  
Seung-Jin Lee, Florida State University  
Kyunghwa Cho, Florida State University  
Yanyun Yang, Florida State University

## 8.4 Damian Betebenner **3:30 – 5:15 PM Salon 19**

### Breakout

- **Damian Betebenner**, Associate at The National Center for the Improvement of Educational Assessment

## 8.5 Psychometrics **3:30 – 5:15 PM Salon 20**

- **Additive Models for Multitrait-Multimethod Data Assuming a Multiplicative Trait-Method Relationship: A Simulation Study**  
Lidong Zhang , University of Florida  
Rong Jin, University of Florida  
Walter Leite, University of Florida  
James Algina, University of Florida
- **An Examination of Non-Normality of Latent Variables in CFA Models**  
Xinya Liang, Florida State University  
Haiyan Wu, Florida State University  
Yanyun Yang, Florida State University
- **Outcomes From a Randomized Trial: Comparison of Results When Treating Data as Continuous, Ordered Categorical, and Unordered Categorical**  
Kristina N. LaVenia, Florida State University  
Mark LaVenia, Florida State University  
Laura B. Lan, Florida State University  
Robert C. Schoen, Florida State University
- **Equating Invariance for English Language Learner Students on a Fifth Grade State Science Exam**

# Thursday November 18

Anne Corinne Huggins, University of Miami

## **EVENING RECEPTION**

**5:30 p.m. – 7:30 p.m.**

**Signature 2 Ballroom**

***Sponsored by:***

**CORE K12 Education**

**Meet our Sponsor:**

**Dianne Bean**

**General Manager, Southeast**

**Brenda Bartholomew**

**Regional Research and Assessment Consultant**

**Technical Support by**

**Fady Boctor, eInstruction**

---

### **Graduate Student Informal Social**

Please join us in the lobby Thursday evening following the Evening Reception. At 7:45pm. As a group, we can take the I-Drive trolley to a nearby and affordable location for after-hours graduate student socializing."

Thursday November 18

# Friday November 19

**Invited Speakers**

**9:00 AM – 10:30 AM Signature 2**

## **Putting Theory Into Practice - Evaluating Teacher Effectiveness in Hillsborough County Public Schools**

**David J. Steele,**

Chief Information and Technology Officer/  
Grant Director, Empowering Effective Teachers  
(EET)

**Anna Brown,**

Director, Assessment and Performance,  
Empowering Effective Teachers (EET)

## 9.2 Student Achievement

10:45 – 12:15

Salon 20

- **Student -- and School -- level Demographic and Achievement Determinants of the Ninth Grade Algebra I Placement**  
Will Tyson, University of South Florida  
Rheta Lanehart , University of South Florida
- **Investigating Race and Ethnicity as Predictors of 8th Grade Students Math FCAT Scores; A Multilevel Study Examining the Achievement Gaps**  
Claudia Güerere, University of South Florida  
Andrew Gump, University of South Florida  
George Macdonald, University of South Florida
- **The Achievement Gap: A 5 by 4 Factorial MANOVA for GPA, NRT, Writing and Teach Recommendations**  
George MacDonald, University of South Florida  
Brian Mann, University of South Florida
- **Adolescent Temperament, Learning Styles, and Course Performance**  
Ekaterina Rybakova, Florida State University  
Shelbie Witte, Florida State University

# Friday November 19

## 9.3 Psychometrics 2

10:45 – 12:15

Salon 21

- **A Grounded Theory of Connectivity and Persistence in a Limited Residency Doctoral Program**  
Steven R. Terrell, Nova Southeastern University  
Martha M. Snyder, Nova Southeastern University  
Laurie A. Dringus, Nova Southeastern University  
Elizabeth Maddrey, Kaplan University
- **Multilevel IRT Approach to Detect Differential Item Functioning for Mixed Tests**  
Burcu Atar, Hacettepe University
- **The Effect Size Indices in Regression Model**  
Rae Seon Kim, Florida State University  
Betsy Jane Becker, Florida State University
- **Examining the Relationship Between Item Difficulty of a Reading Test and Differential Item Functioning**  
Jin Koo, Florida State University  
Betsy Jane Becker -- Florida State University

---

## FERA Luncheon

12:30 – 2:00

Salon 7/8

## Annual Business Meeting and Awards Luncheon

Sponsored by:

## Pearson Learning Assessments

Meet our Sponsor: Michael Keaton

Michael Keaton



## First Author Contact Information

<b>Name</b>	<b>Email</b>
Allsopp, Margaret	mallsopp@mail.usf.edu
Atar, Burcu	burcua@hacettepe.edu.tr or burcugulum@gmail.com
AYDIN, Burak	burakaydin@ufl.edu
Bai, Haiyan	hbai@mail.ucf.edu
Brummer, Richard F.	rbrummer@mail.usf.edu
Cocke, Jacquelin W.	jwc04c@fsu.edu
Dennis, Danielle V.	Dennis@usf.edu
Dickenson, Wendy D.	wbdickenson@aol.com
DOGAN, Yakup	ydogan@fsu.edu
Felsch, Paul	felschp@leonschools.net
Gardner, Margaret C.	jmgators@embarqmail.com
Güerere, Claudia	cguerere@mail.usf.edu
Güerere, Claudia	cguerere@mail.usf.edu
Haciomeroglu, Erhan Selcuk	erhansh@mail.ucf.edu
Huggins, Anne Corinne	corinnehuggins@gmail.com
Hughes, Roxanne	rmh05e@fsu.edu
Hwang, Sung-on	sh07@fsu.edu
Jordan, Beth E.	bejordan@mail.usf.edu
Kaya, Yasemin	yaseminkaya@ufl.edu
Kim, Rae Seon	rsk05@fsu.edu
Koo, Jin	jk06m@fsu.edu
LaVenía, Kristina N.	klavenia@gmail.com
Lee, Seung-Jin	sl02e@fsu.edu

# First Author Contact Information

<i>Name</i>	<i>Email</i>
Liang, Xinya	xinyaaa@gmail.com
Lieberman, Mary G.	mlieberm@fau.edu
Liu, Qian	ql03@fsu.edu
MacDonald, George	gmacdona@mail.usf.edu
Maerten-Rivera, Jaime	jmaerten-rivera@miami.edu
Maslin-Ostrowski, Pat	pmaslin@fau.edu
Molina, Roxanne	rmoli002@fiu.edu
Morehead, Kelly	kmorehea@mail.ucf.edu
Nisbet, Leslie	lnisb001@fiu.edu
Orcan, Fatih	fo08c@fsu.edu
Ouma, Christine	co09f@fsu.edu
Park, Young-Hee	yhp06@fsu.edu
Rodriguez de Gil, Patricia	prodrig6@usf.edu
Rybakova, Ekaterina	Er07c@fsu.edu
Shaunessy, Elizabeth	Shaunessy@usf.edu
Stewart, Shelley	mkstewart@usf.edu
Swan, Bonnie	bawan@mail.ucf.edu
Terrell, Steven R.	terrell@nova.edu
Tyson, Will	wtyson@cas.usf.edu
Vogel-Walcutt, Jennifer J.	jvogel@ist.ucf.edu
Zelenak, Michael S.	zelenak@mail.usf.edu
Zhang, Lidong	liz34@ufl.edu

# Paper Reviewers

Betsy Becker,  
Florida State University

Aarti Bellara,  
University of South Florida

Monifa Green Beverly,  
University of Central Florida

Mustafa Kuzey Bilir,  
Pearson

Lantry L. Brockmeier,  
Valdosta State University  
Murat CANLI,

Celal Bayer University

Robert Dedrick,  
University of South Florida

Wendy Dickinson,  
Ringling College of  
Art and Design

Maressa L. Dixon,  
University of South Florida

Oktay Donmez,  
Florida State University

Meichu Fan,  
Pearson

Robert H. Fay,  
University of South Florida

Renita Ferreir,  
Florida International University

John Ferron,  
University of South Florida

Sandra Fletcher,  
Florida International University

Hiroataka Fukuhara,  
FDOE

Karina Gattamorta,  
University of Miami

Erhan Selcuk Haciomeroglu,  
University of Central Florida

Debbie L. Hahs-Vaughn,  
University of Central Florida

Gene Hoffman,  
HumRRO

Anne Corinne Huggins,  
University of Miami

Roxanne Hughes,  
Florida State University

Akihito Kamata,  
University of Oregon

Ayhan Karaman,  
Onsekiz Mart University

Esra Kocyigit,  
Florida State University

Sharon Koon,  
FDOE

Walter L. Leite,  
University of Florida

## Paper Reviewers

Xinya Liang,  
Florida State University

Mary G. Lieberman,  
Florida Atlantic University

Qian Liu,  
FDOE

Teresa Lucas,  
Florida International University

George MacDonald,  
University of South Florida

Jaime Maerten-Rivera,  
University of Miami

Pat Maslin-Ostrowski,  
Florida Atlantic University

Julie McLeod,  
Hillsborough County  
Public Schools

M David Miller,  
University of Florida

Dan Morris,  
Florida Atlantic University

Yvette M. Nemeth,  
HumRRO

Derek Pasisz,  
Florida State University

Patricia Rodriguez,  
University of South Florida

Fay Roseman,  
Barry University

Mark D. Shermis,  
The University of Akron

In-Soo Shin,  
Jeon-Ju University

Patti Simmons,  
Hillsborough County Public Schools

Shelley Stewart,  
University of South Florida

Mitchell Sullivan,  
Florida State University

Steven R. Terrell,  
Nova Southeastern University

Ahmet Turhan,  
Pearson

Tary Wallace,  
University of South Florida

Hesborn Wao,  
University of South Florida

YANYUN YANG,  
Florida State University

Maryam Soltan Zadeh,  
Florida International University

Ying Zhang,  
Florida State University

# 2010 FERA Executive Committee

President	John Ferron, University of South Florida
President Elect	Frank Gilbert, Orange County Public Schools
Past President	Wendy Dickinson, Ringling College of Art & Design
Secretary	Kathy Dailey, Polk County Public Schools
Treasurer	Julie McLeod, Hillsborough Public Schools
Director	Salih Binici, Florida Department of Education
Director	Donna Buckner, Polk County Public Schools
Director	Abbas Tashakkori, University of North Texas

## 2010 Standing Committee Chairs

Website/Newsletter	Lisa Adkins, University of South Florida
Graduate Students) Coordinators	Kristina LaVenía Florida State University  Corinne Huggins University of Miami
Publications: FERJ	Jeffrey Kromrey, University of South Florida
Professional Education and Training	Robert Dedrick, University of South Florida
Membership	Bonnie Swan, University of Central Florida

# Graduate Student Volunteers

Allen, Diedre	Margarella, Erin
Blankenship, Matt	Misieng, Jecky
Cao, Chunhua	Molina, Roxanne
Clements, Taylor	Nehrig, Paul
Cocke, Jackie	Nguyen, Diep
Crissman, Monica	Ofuani, Chika
Dames, Jennifer	Orcan, Fatih
Gelfuso, Andrea	Pashnyak, Tatyana
Grey, Elizabeth	Pham, Than
Guerere, Claudia	Pontier, Ryan
Hart, Matthew	Rodriguez, Patricia
Hauptli, Meghan	Saslovsky, Christina
Huggins, Corinne	Smith, Patriann
Kelly, Suzette	Soden-Hensler, Brooke
Kyeng Baek, Eun	Thompson, Christopher
Lavery, Matt	Wegrzyn, Deborah
Long, Carol	Weisberger, Jeff
Lott, Laurie	Welsh, James
MacDonald, George	

# Contacts

# Notes